

TAPERED ROLLER BEARINGS

Inch Bore & Metric Bore Cup and Cone Sets

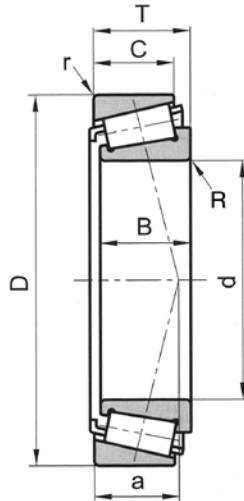

HLU Part No.	(in.) (mm) Dimensions							
	d	D	T	B	C	R min	r min	a (mm)
LM11749/LM11710	0.6875 17.462	1.5700 39.878	0.5450 13.843	0.5750 14.605	0.4200 10.668	0.05 1.3	0.05 1.3	8.60
LM11949/LM11910	0.7500 19.050	1.7810 45.237	0.6100 15.494	0.6550 16.637	0.4750 12.065	0.05 1.3	0.05 1.3	9.83
M12649/M12610	0.8437 21.4330	1.9687 50.005	0.6900 17.526	0.7200 18.288	0.5500 13.970	0.05 1.3	0.05 1.3	10.75
LM12749/LM12710	0.8656 21.986	1.7810 45.237	0.6100 15.494	0.6550 16.637	0.4750 12.065	0.05 1.3	0.05 1.3	10.07
LM12749/LM12711	0.8656 21.986	1.8100 45.974	0.6100 15.494	0.6550 16.637	0.4750 12.065	0.05 1.3	0.05 1.3	10
L44643/L44610	1.0000 25.400	1.9800 50.292	0.5600 14.224	0.5800 14.732	0.4200 10.668	0.05 1.3	0.05 1.3	10.75
L44649/L44610	1.0625 26.988	1.9800 50.292	0.5600 14.224	0.5800 14.732	0.4200 10.668	0.14 3.5	0.05 1.3	10.75
LM67048/LM67010	1.2500 31.750	2.3280 59.131	0.6250 15.875	0.6600 16.764	0.4650 11.811	0.14 3.6	0.05 1.3	12.87
15123/15245	1.2500 31.750	2.4409 62.000	0.7150 18.161	0.7500 19.050	0.5625 14.288	0.14 3.6	0.05 1.3	12.68
14125A/14276	1.2500 31.750	2.7170 69.012	0.7813 19.845	0.7710 19.583	0.6250 15.875	0.14 3.5	0.05 1.3	*
LM48548/LM48510	1.3750 34.925	2.5625 65.088	0.7100 18.034	0.7200 18.288	0.5500 13.970	0.14 3.6	0.05 1.3	*
L68149/L68110	1.3775 34.988	2.3280 59.131	0.6250 15.875	0.6600 16.764	0.4700 11.938	0.14 3.5	0.05 1.3	13.42
L68149/L68111	1.3775 34.988	2.3612 59.974	0.6250 15.875	0.6600 16.764	0.4700 11.938	0.14 3.5	0.05 1.3	13.42
JL69349/JL69310	1.4961 38.000	2.4803 63.000	0.6693 17.000	0.6693 17.000	0.5315 13.500	0.14 3.6	0.05 1.3	14.28
LM29748/LM29710	1.5000 38.100	2.5625 65.088	0.7100 18.034	0.7200 18.288	0.5500 13.970	0.14 3.6	0.05 1.3	13.46
LM29749/LM29710	1.5000 38.100	2.5625 65.088	0.7100 18.034	0.7200 18.288	0.5500 13.970	0.09 2.3	0.05 1.3	13.46
LM501349/LM501310	1.6250 41.275	2.8910 73.431	0.7700 19.558	0.7800 19.812	0.5800 14.732	0.14 3.5	0.03 0.8	15.94
25580/25520	1.7500 44.450	3.2650 82.931	0.9375 23.812	1.0000 25.400	0.7500 19.050	0.14 3.5	0.03 0.8	16.993
LM603049/LM603011	1.7812 45.242	3.0625 77.788	0.7812 19.842	0.7812 19.842	0.5937 15.080	0.14 3.5	0.03 0.8	17.07
LM104949/LM104911	2.0000 50.800	3.2500 82.550	0.8500 21.590	0.8750 22.225	0.6500 16.510	0.14 3.5	0.05 1.3	15.37

* Call Hi-Light USA sales staff for information.

Note: "a" dimension is axial distance from back face of the cone to effective load center.

TAPERED ROLLER BEARINGS

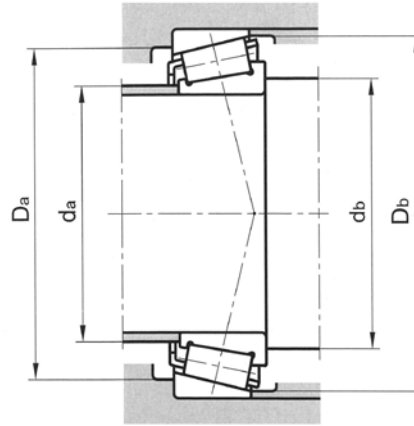
Inch Bore & Metric Bore Cup and Cone Sets

Basic Load Rating		Limiting Speed (r/min)		Weight (lbs) (kg)	Mounting Dimensions (mm)				Calculation Factors		
Dynamic Cr (KN)	Static Cor (KN)	Grease	Oil		da max	db min	Da max	Db min	e	y	Y_0
22.90	23.40	15000	18000	0.18 0.08	23	23.5	35	36	0.29	2.10	1.15
30.60	32.00	13000	16000	0.26 0.12	26	26	38	41	0.30	2.00	1.10
40.80	43.50	11000	15000	0.36 0.16	28	28.5	43.5	46	0.28	2.16	1.19
30.20	35.30	12000	15000	0.26 0.12	28	29	39	42	0.31	1.96	1.08
30.20	35.30	12000	15000	0.26 0.12	28	28	39	42	0.31	1.96	1.08
27.80	32.90	11000	13000	0.26 0.12	33	32.5	44	47	0.37	1.60	0.88
27.80	32.90	11000	13000	0.24 0.11	33	38.5	44	47	0.37	1.60	0.88
36.50	44.60	9500	11000	0.37 0.17	38	42	51	55	0.41	1.46	0.80
46.80	53.90	9000	11000	0.51 0.23	38	44	54	58	0.35	1.71	0.94
50.60	61.70	*	*	0.75 0.34	*	*	*	*	0.38	1.57	0.86
50.50	63.10	8500	11000	0.57 0.26	42	46	57	61	0.38	1.59	0.88
35.50	49.30	9000	11000	0.37 0.17	41	46	52	56	0.42	1.44	0.79
35.50	49.30	9000	11000	0.40 0.18	41	47	52	56	0.49	1.44	0.79
39.80	55.00	8500	10000	0.42 0.19	44	50.5	56	60	0.42	1.44	0.79
45.00	60.30	8000	10000	0.49 0.22	44	47	58	61	0.33	1.80	0.99
45.00	60.30	8000	10000	0.49 0.22	44	47	58	61	0.33	1.80	0.99
58.40	74.20	7500	9000	0.71 0.32	48	53.5	64	69	0.40	1.50	0.83
83.80	111.00	6700	8000	1.21 0.55	53	57	71	76	0.33	1.79	0.99
59.60	77.90	7000	8500	0.79 0.36	52	58	68	74	0.43	1.41	0.77
75.20	104.00	6000	8000	0.93 0.42	57	62	72	77	0.31	1.97	1.08