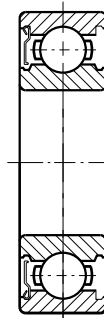
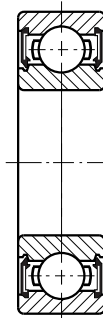
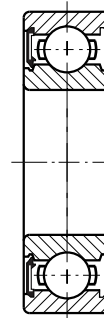

**ZZ**  
Shielded  
Both Sides

**Z**  
Shielded  
1 Side Only

**2RS**  
Sealed  
Both Sides

**RS**  
Sealed  
1 Side Only

HLU Bearing No.	Dimensions (in./mm)							Basic Load Ratings lbs		Weight lbs	Limiting Speed of Open Bearing rpm	
	Bore d	Tolerance +.0000 to minus .008	OD D	Tolerance +.0000 to minus .009	Width B	Tolerance +.0000 to minus .12	Fillet Radius *r	Dynamic Cr	Static Cor		grease	oil
**608	0.3150 8	.0003 .008	.8661 22	.0035 .009	0.2756 7	.0047 .12	0.012 0.3	740	306	0.024	26000	34000
6000	0.3937 10	.0003 .008	1.0236 26	.00035 .009	0.3150 8	.0047 .12	0.012 0.3	935	400	0.042	29000	34000
6001	0.4724 12	.0003 .008	1.1024 28	.00035 .009	0.3150 8	.0047 .12	0.012 0.3	1149	535	0.049	26000	30000
6002	0.5906 15	.0003 .008	1.2598 32	.00045 .011	0.3543 9	.0047 .12	0.012 0.3	1257	638	0.066	22000	26000
6003	0.6693 17	.0003 .008	1.3780 35	.00045 .011	0.3937 10	.0047 .12	0.012 0.3	1349	731	0.086	20000	24000
6004	0.7874 20	.0004 .010	1.6535 42	.00045 .011	0.4724 12	.0047 .12	0.0236 0.6	2113	1135	0.152	18000	21000
6005	0.9843 25	.0004 .010	1.8504 47	.00045 .011	0.4724 12	.0047 .12	0.0236 0.6	2270	1315	0.176	15000	18000
6006	1.1811 30	.0004 .010	2.1654 55	.0005 .013	0.5118 13	.0047 .12	0.0394 1.0	2967	1866	0.256	13000	15000
6007	1.3780 35	.0005 .012	2.4409 62	.0005 .013	0.5512 14	.0047 .12	0.0394 1.0	3597	2315	0.342	12000	14000
6008	1.5748 40	.0005 .012	2.6772 68	.0005 .013	0.5906 15	.0047 .12	0.0394 1.0	3777	2585	0.419	10000	12000
6009	1.7717 45	.0005 .012	2.9528 75	.0005 .013	0.6299 16	.0047 .12	0.0394 1.0	4721	3394	0.522	9200	11000
6010	1.9685 50	.0005 .012	3.1496 80	.0005 .013	0.6299 16	.0047 .12	0.0394 1.0	4901	3732	0.575	8400	9800
6011	2.1654 55	.0006 .015	3.5433 90	.0006 .015	0.7087 18	.006 .15	0.0433 1.1	6362	4766	0.855	7700	9000
6012	2.3622 60	.0006 .015	3.7402 95	.0006 .015	0.7087 18	.006 .15	0.0433 1.1	6632	5215	0.913	7000	8300
6013	2.5591 65	.0006 .015	3.9370 100	.0006 .015	0.7087 18	.006 .15	0.0433 1.1	6856	5665	0.928	6500	7700
6014	2.7559 70	.0006 .015	4.3307 110	.0006 .015	0.7874 20	.006 .15	0.0433 1.1	8542	6969	1.332	6100	7100
6015	2.9528 75	.0006 .015	4.5276 115	.0006 .015	0.7874 20	.006 .15	0.0433 1.1	8880	7531	1.431	5700	6700
6016	3.1496 80	.0006 .015	4.9213 125	.0007 .018	0.8661 22	.006 .15	0.0433 1.1	10678	8992	1.883	5300	6200
6017	3.3465 85	.0008 .020	5.1181 130	.0007 .018	0.8661 22	.008 .20	0.0433 1.1	11128	9666	1.962	5000	5900
6018	3.5433 90	.0008 .020	5.5118 140	.0007 .018	0.9449 24	.008 .20	0.0591 1.5	13038	11128	2.249	4700	5600
6019	3.7402 95	.0008 .020	5.7087 145	.0007 .018	0.9449 24	.008 .20	0.0591 1.5	13600	12139	2.381	4500	5300
6020	3.9370 100	.0008 .020	5.9055 150	.0007 .018	0.9449 24	.008 .20	0.0591 1.5	13488	12139	2.535	4200	5000

\* Maximum shaft or housing fillet radius that bearing corners will clear.

C3 internal clearance fit on standard stock items.

\*\* 608 is a 600 series miniature bearing.